



DEPARTMENT: ENVIRONMENTAL AFFAIRS AND TOURISM
REPUBLIC OF SOUTH AFRICA

Directorate: Antarctica and Islands
Private Bag X 447
PRETORIA
0001

Enquiries : J A Dreyer
Telephone : 012 3103539
Facsimile : 012 3103500
File : A15/1/2/1/2 & A514/2
E-mail : adreyer@deat.gov.za

CHIEF DIRECTOR: MARINE AND COASTAL MANAGEMENT
SHIP'S OPERATIONS MANAGER
NDPW PROJECT MANAGER

SAILING INSTRUCTIONS: MV SA AGULHAS: MARION ISLAND
VOYAGE 124: 16 - 2 SEPTEMBER 2005

1. The *mv S.A. Agulhas* will depart from Cape Town harbour on 16 August 2005 at 10:00 on the second leg of the 2005 construction voyage to Marion Island.
2. The passenger lists (Annexure A), voyage schedules (Annexure B) and cabin allocations (Annexure C and D) are attached for your further attention.

3. **TRAVEL DOCUMENTS**

All persons accompanying the voyage must be in possession of valid passport and residence or visitor's permits where applicable. The afore-mentioned documents must be handed to the Catering Officer (Purser) at least 24 hours prior to departure. Persons not complying with this request will be responsible for arranging their own customs and immigration clearance. The ship will not be delayed for this purpose.

4. **GENERAL**

There are various rules and regulations pertaining to the code of conduct on board the *mv S.A. Agulhas* and base stations. These are explained in the attached document (Annexure F) "Organisation of Operations and Conduct of Participants in the South African Antarctic Programme".

Additional points to be noted are:

- (a) Alcohol may not be taken aboard for the duration of the voyage. There will be a bar facility on board the ship. No credit on the bar facility will be allowed. Passengers who want to make use of the bar facility will have to pay the Catering Officer a deposit. Any purchases there after will be deducted from the deposit accordingly. Only passengers that have paid the deposit will be served at the bar. All outstanding canteen, bar and radio accounts must be paid to the Catering Officer before leaving the ship at the end of the voyage.
- (b) The dress code for breakfast is casual (e.g. tracksuit pants, neat T shirt and running shoes "takkies") lunch and evening meals on board the mv S.A. Agulhas is smart casual. Individuals not adhering to this code may be asked to leave the dining room. Alternative meal schedules and eating places on the ship are to be arranged well in advance by the DCO, if the work programme is such that adherence to normal times and places is not possible.
- (c) Domestic facilities and accommodation at the base station are limited. Those staying at the Bases should anticipate a degree of discomfort and/or inconvenience. Nobody will be allowed, on board the ship and/or at the base station, to change accommodation as allocated without the approval of the DCO of the voyage.
- (d) All persons will be expected to assist with domestic chores on board the ship and at the base station as required by the DCO.
- (e) All ship and station-based persons will be expected to assist with all logistical work as decided by the DCO. This will include ship to shore off loading, unpacking of DEAT containers and any other logistics as decided by the DCO. Leave of absence from this activity, for bona fide reasons, may only be negotiated with the DCO on condition that the responsible Group Leader also gives approval for such leave. For obvious reasons, the more hands available both ashore and on the ship to assist with logistics, the sooner it will be completed.
- (f) Nobody is allowed to approach the Group Leader of the CHC to arrange a "flip" in the helicopter(s). The only person to task and approve any flights and/or accompanying passengers for the duration of the voyage will be the DCO of the voyage.
- (g) Medical assistance is available. However, persons suffering known ailments are to ensure that they take adequate medication for the full duration of the relief voyage. Chronic medication will not be provided.

DIRECTOR: ANTARCTICA AND ISLANDS

DATE:

**PASSENGER LIST VOYAGE 124 - 16 AUGUST 2005
CAPE TOWN TO MARION ISLAND**

Annexure A

DEPARTMENT OF ENVIRONMENTAL AFFAIRS AND TOURISM (DEAT)

Departmental Co-ordinator (DCO) - Mr. J A Dreyer
Project Leader & Project Environmental Officer
Chef - WO C Heroldt
Chef - Cpl H Haines
Kitchen assistant - Mr M Mitchel
Doctor - Dr Liliana de Fatima Conde de Jesus Santos

HELICOPTER SUPPORT (CHC)

Group Leader

- Capt. Andre Stroebe
- F/O G Pistorius
- F/E John Britton
- F/O Donavon Kohl (to stay on Island)
- F/E K Bandelow
- Capt. P Costa (to stay on Island)
- Eng S Greeff (to stay on Island)
- Eng F Marais
- FM T Roux
- Appr. A Lipumbu
- Appr. A Sauer
- Capt M Louw

SOUTH AFRICAN WEATHER SERVICE (SAWS)

Group Leader

- Ms C Rae (to return with ship)
- Mr E Vermeulen (to return with ship)

PEIMC

Group Leader

- Ms S Davies (to return with ship)
- Ms L Joubert (to return with ship)

ENDECON

Group Leader

- Mr. C. Erasmus

NATIONAL DEPARTMENT OF PUBLIC WORKS

Construction Manager
Logistics Leader
Electrical Leader
Building Leader
Mechanical Leader (1)
Mechanical Leader (2)

- Mr M Murphy
- Mr G E G Louw
- Mr H Smith
- Mr G Hardenberg
- Mr A Rocha
- Mr D du Toit
- Mr C Kitshoff
- Mr J Tebbutt
- Mr J Parsons
- Mr N Mentoor
- Mr S Hamdulay
- Mr N Dike
- Mr M Mahe
- Mr M. Iantlala

VOYAGE SA AGULHAS

DEPARTURE	ARRIVAL	NAME	REMARKS
August 2005	10 August 2005	Mr A Magwa	
August 2005	10 August 2005	Mr E Bizaare	
August 2005	10 August 2005	Mr W vd Westhuizen	
August 2005	10 August 2005	Mr M de Jongh	
August 2005	10 August 2005	Mr T Lala	
August 2005	10 August 2005	Mr J van Niekerk	
August 2005	10 August 2005	Mr M Porta Nova	
August 2005	10 August 2005	Mr G Hendricks	
August 2005	10 August 2005	Mr R Meshillie	
August 2005	10 August 2005	Mr W Samsodien	
August 2005	10 August 2005	Mr C Ackerman	
August 2005	10 August 2005	Mr G Bissett	
August 2005	10 August 2005	Mr L Ferreira	
August 2005	10 August 2005	Mr J Mahlangu	
August 2005	10 August 2005	Mr M Maloka	
August 2005	10 August 2005	Mr K Mzamane	
August 2005	10 August 2005	Mr L Meek	
August 2005	10 August 2005	Mr D Modisenyane	
August 2005	10 August 2005	Mr R van Zyl	
August 2005	10 August 2005	Mr W Mkhwanazi	
August 2005	10 August 2005	Mr A Seysi	
August 2005	10 August 2005	Mr C Stoltz	
August 2005	10 August 2005	Mr J Mosotho	
August 2005	10 August 2005	Mr R Ratscala	
August 2005	10 August 2005	Mr M Freitas Dos Santos (to return with ship)	

Table and notes are subject to change

VOYAGE SCHEDULE

SA AGULHAS ~ AUGUST 2005

PRE-DEPARTURE

5 August - 12 August 2005	Load construction cargo	6 days
As per Gant chart	Cargo declaration and cargo loading	As per Gant chart
To be confirmed	Jet A1 bunker fuel	25 000 litres & 120 x 200L drums
As per Gant chart	Issuing of protective clothing	
CHC to confirm	Helicopters onboard (S61 & B212)	To be confirmed
16 August 2005	Departure for Marion Island at 10h00 (Gang way will be lifted at 09h45)	ETD Cape Town (Quay 500)

VOYAGE 123

DEPARTURE	ARRIVAL	ACTION	DURATION
16 August 2005 & 10:00 (Quay 500 - Cape Town)	21 August 2005 (Marion Island)	Voyage to Marion Island	5 Days
Voyage summary 21 - 28 August 2005	Offloading period	> Discharge personnel and construction cargo	8 Days for offloading
Approx 28 August 2005 ETD Marion Island	Approx 2 September 2005 ETA Cape Town Harbour	> Voyage to Cape Town	5 Days

NOTE

- Dates and times are subject to change.

PASSENGER CABIN ALLOCATION

Annexure D

VOYAGE NUMBER 124 12 August 2005 FROM Cape Town TO: Marion Island

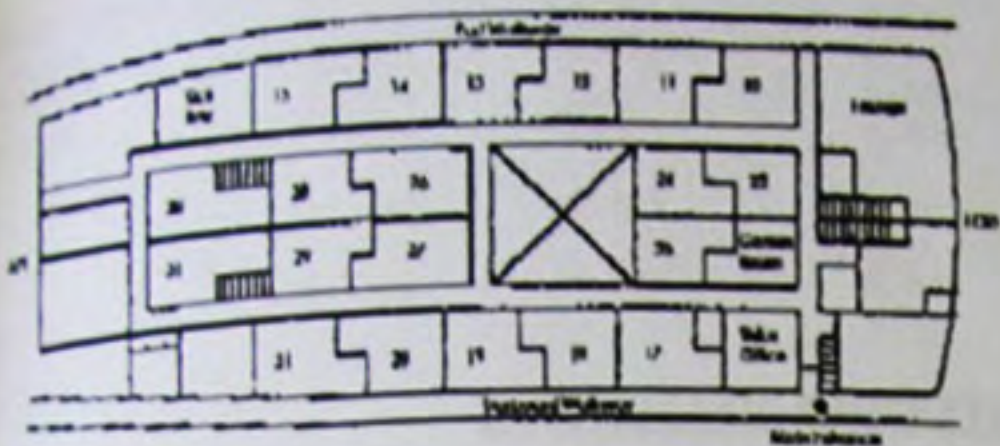
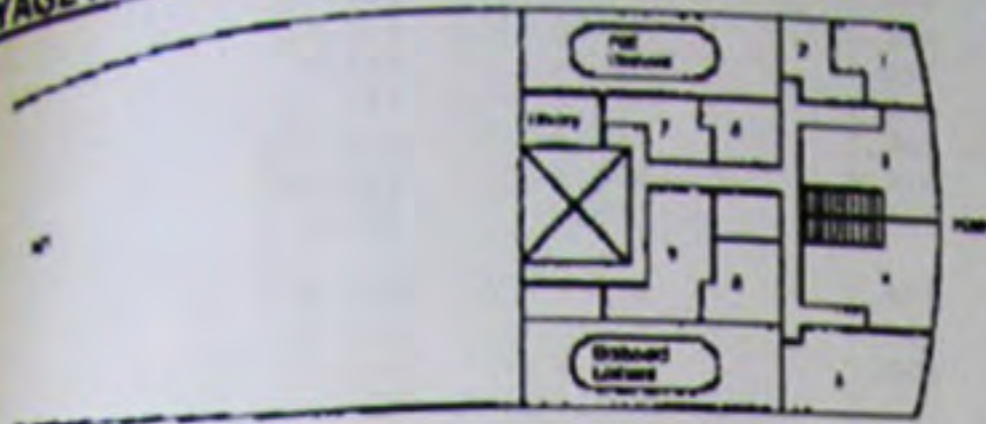

No	NAME	No	NAME	No	NAME	No	NAME
1	a DR L SANTOS	10	a N MENTOOR	17	a D KOEHL	24	a E VERMEULEN
	b		b M DE JONGH		b P COSTA		b
	2		a JA DREYER		c N DIKE	c	25
3	a C ERASMUS	11	d	18	d	26	b C KITSHOFF
	b H SMITH		a A MAGWA		a S GREEFF		a M MITCHEL
	c		b M JANTJIES		b F MARAIS		b F DOS SANTOS
	d		c J V NIEKERK		c T ROUX		c
4	a A ROCHA	12	d	19	d	27	d
	b D DU TOIT		a M PORTA-NOVA		a A IPUMBU		a K MZAMANE
	c G HARDENBERG		b J TEBBUTT		b S HANSEN		b D MODISENYANE
	d		c		c		c W MKHWANAZI
5	a M MURPHY	13	d	20	d	28	d
	b G LOUW		a E BIZAARE		a C RAE		a R V ZYL
	c		b G HENDRICKS		b S DAVIES		b C ACKERMAN
	d		c M MAHE		c JOUBERT		a L FERREIRA
6	a	14	d	21	d	29	b C STOLTZ
	b DOCTORS CABIN		a T LALA		a R MESHILINIE		a G BISSETT
7	a M LOUW	15	b J MAHLANGU	22	b W SAMSODIEN	30	b L MEEK
	a A STROEBEL		c J MOSOTHO		c S HAMDULAY		c J PARSONS
	b		d		d		d
8	a J BRITTON	15	a R RATSCLA	22	a C HEROLDT	31	a
	b G PISTORUIS		b A SEYISI		b H HAIMES		b
	c K BANDLOW		c M MALOKA		PURSERS CABIN		c
	d		d				d